

UNIT 1, ARROW VALLEY

Claybrook Drive, Redditch B98 0FY



Key Highlights

- Modern, Steel Frame Warehouse
- Detached Unit
- Prominent location
- EPC “B” Rating
- Established Industrial Area
- Fully Refurbished
- Established Industrial Estate
- Secure Gated Yard
- Dock Loading
- 32,417 sq ft to let
- Two storey external offices
- 6.12m eaves
- Available June 2019
- Up to 45 Parking spaces available

SAVILLS BIRMINGHAM
55 Colmore Row
Birmingham B3 2AA

+44 (0) 121 634 8400

savills.co.uk

The Savills logo, consisting of the word 'savills' in a lowercase, sans-serif font, with the 's' in 'savills' being a larger, stylized 'S'. The logo is set against a yellow rectangular background.

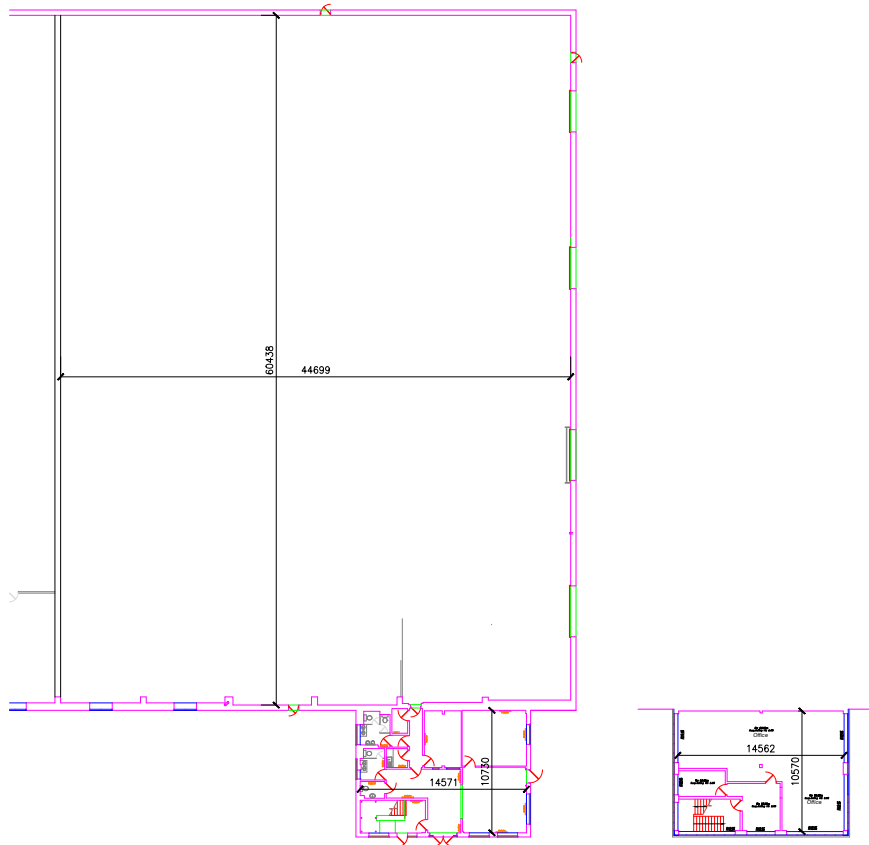

Location

The property is located off Claybrook Drive, Redditch in an established industrial area. The unit provides easy access to J3 M42 via the A435 which is located approximately 5 miles north of the unit.

Description

The property comprises;

- A single storey steel portal frame warehouse,
- Fully refurbished two storey office block
- Warehouse eaves height of 6.12m
- Two electric roller shutter doors (4m x 5m)
- Two dock loading doors
- Suspended high bay sodium lights and grid strip lighting
- 10% Natural roof lighting
- Concrete floor
- Three phase power
- Gas supply and gas fired hot air blowers in the warehouse
- Office Includes; Solid carpeted floors, suspended ceilings, double glazing, Male and Female WC's
- A secure yard

Accommodation

We have measured the premises in accordance with the RICS Code of Measuring Practice (6th Edition) as follows:

FLOOR AREA	SQ FT
Warehouse	29,079
Ground Floor Offices	1,683
First Floor Offices	1,657
Total	32,417

Tenure

Available on a new FRI lease.

EPC

The property has an EPC rating of B(49).

Rent

Quoting rent of £6.25 psf exc VAT.

VAT

VAT will be payable on the transaction.

Viewing

By appointment only through the sole agents.

SAVILLS BIRMINGHAM
55 Colmore Row
Birmingham B3 2AA

+44 (0) 121 634 8400

savills.co.uk

savills

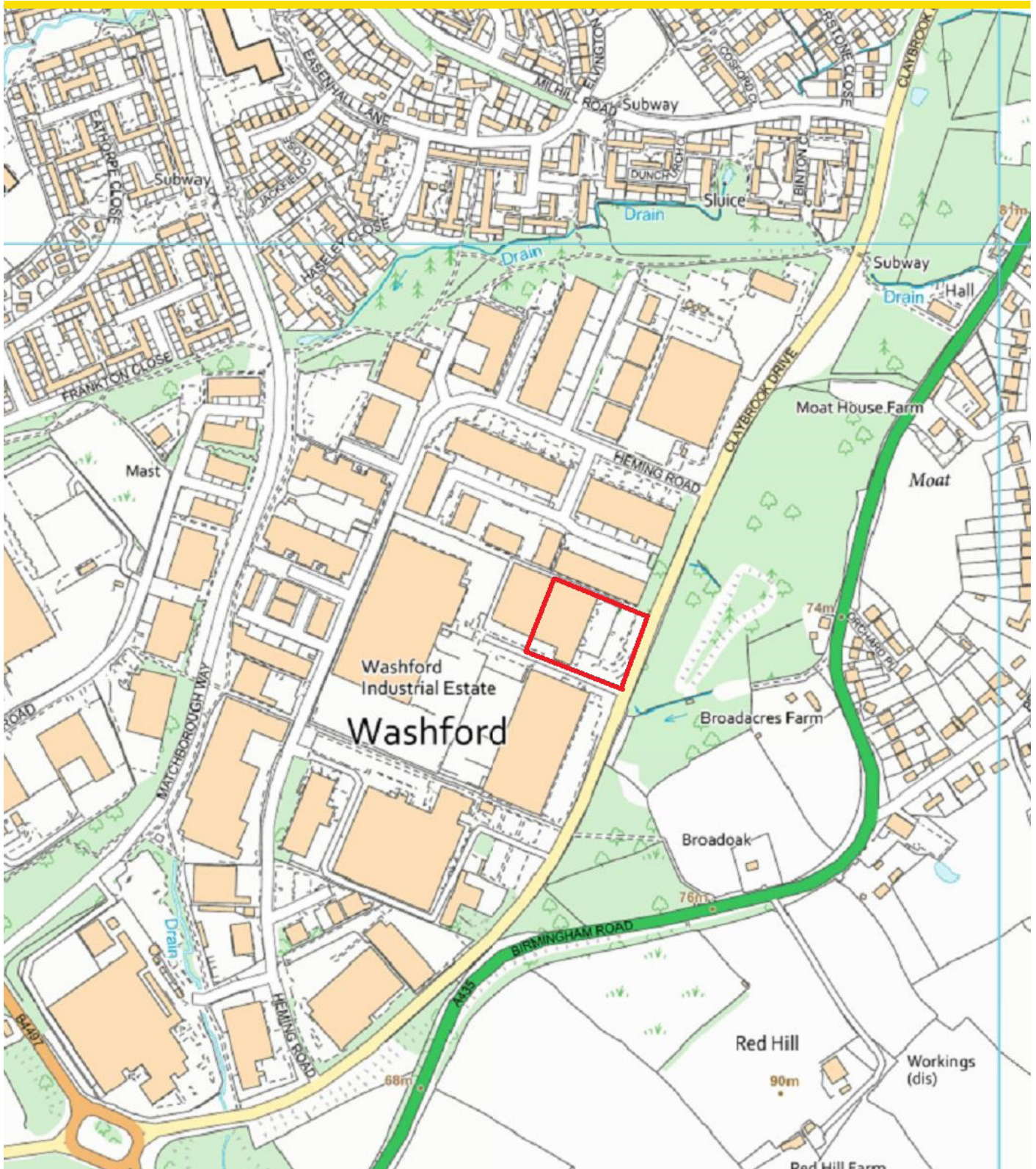

Contact

Christian Smith

+44 (0) 1212 004 507
christian.smith@savills.com

Hugh Walton

+44 (0) 1216 152 663
hugh.walton@savills.com

IMPORTANT NOTICE

Maps are reproduced from the Ordnance Survey Map with the permission of the Controller of H.M. Stationery Office. © Crown copyright licence number 100022432 Savills (UK) Ltd, published for the purposes of identification only and although believed to be correct accuracy is not guaranteed.

Savills, their clients and any joint agents give notice that: 1. They are not authorised to make or give any representations or warranties in relation to the property either here or elsewhere, either on their own behalf or on behalf of their client or otherwise. They assume no responsibility for any statement that may be made in these particulars. These particulars do not form part of any offer or contract and must not be relied upon as statements or representations of fact. 2. Any areas, measurements or distances are approximate. The text, photographs and plans are for guidance only and are not necessarily comprehensive. It should not be assumed that the property has all necessary planning, building regulation or other consents and Savills have not tested any services, equipment or facilities. Purchasers must satisfy themselves by inspection or otherwise.

Designed and Produced by Savills Marketing: 020 7499 8644 | December 2018

savills