

# TO LET

**Substantially Refurbished Offices**  
**2,672 - 3,746 sq ft (248 - 348 sq m)**

# 4 QUINTON BUSINESS PARK



Junction 3 M5  
Birmingham | B32 1AF



**ESTABLISHED BUSINESS PARK | STRATEGIC LOCATION | MODERN ACCOMMODATION**



# 4 QUINTON BUSINESS PARK



Quinton Business Park is an established and prestigious business park situated adjacent to junction 3 of the M5 and on a main arterial route (A456) 5 miles south-west of Birmingham city centre.

4 Quinton Business Park is a high quality headquarters office building with an impressive triple height reception.

Occupiers in the Park include:

- Independent Police Complaints Commission
- Wates
- Serco
- Highways Agency
- Lovell Construction

The available accommodation is located on the ground and first floors and will be fully refurbished to provide contemporary open plan accommodation.





## SPECIFICATION

The suites will be refurbished to provide the following specification:

- VRV full air conditioning system
- Disabled WCs and shower facilities
- Raised access flooring
- Disability Discrimination Act compliant
- Suspended ceilings with LED lighting
- Car parking ratio 1:222 sq ft
- 2 passenger lifts
- Secure managed parkland with 24 hour CCTV coverage
- Male & female WCs
- EPC rating of D98

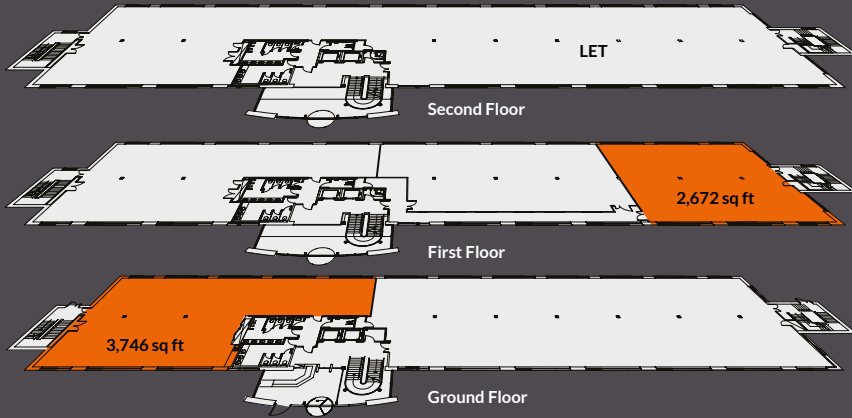

## TENURE

A new lease is available.

## RENT / TERMS

Rental and lease terms available upon application.

## ACCOMMODATION

	sq ft	sq m
Ground Floor	3,746	348
First Floor	2,672	248.2
Second Floor	LET	
<b>Total</b>	<b>6,418</b>	<b>596.2</b>



Indicative refurbishment - 8 Quinton Business Park



Reception to be refurbished



Indicative refurbishment - 8 Quinton Business Park



Immediate access to Junction 3, M5 and only 5 miles from Birmingham City Centre

SATNAV: B32 1AF

**TRAVEL TIMES**

- M5 Junction 3 – 0.7 miles/2 mins
- Excellent range of shops, restaurants and convenience stores on the Hagley Road, 1.2 miles away
- Rowley Regis Train Station (Located on the Birmingham to Worcester line) – 3.6 miles/10 mins
- Birmingham City Centre- 7 Miles/18 mins
- Birmingham Airport – 29 miles/32 mins

**LOCAL BUS ROUTES**

- No.9 – Birmingham to Stourbridge
- 11a and 11c – Outer circle of Birmingham including Kings Heath, Quinton, Bearwood, Harborne
- 24 – Birmingham to Quinton
- 126 – Wolverhampton to Birmingham



**VIEWING**

For further information or to arrange a viewing contact:

**BNP PARIBAS REAL ESTATE**  
**0121 237 1234**  
 realestate.bnpparibas.co.uk

**Mark Robinson**  
 mark.d.robinson@realestate.bnpparibas

**Colliers INTERNATIONAL**  
**0121 265 7500**

**Douglas Bonham**  
 douglas.bonham@colliers.com

Important: These brief particulars have been prepared as agents for our clients and are intended as a convenient guide to supplement an inspection or survey. Their accuracy is not guaranteed. They contain statements of opinion and in some instances we have relied on information provided by others. You should verify the particulars on your visit to the property and the particulars do not obviate the need for a full survey and all the appropriate enquiries. Accordingly, there shall be no liability as a result of any error or omission in the particulars or any other information given. Designed and produced by Q Squared Design Ltd. Tel: 01789 730833. November 2018.